

# Yutaki S Combi

Compact all-in-one system: heating, hot water and cooling with integrated stainless steel tank



## Extensive range of models

The Yutaki S Combi is designed for any type of installation thanks to its wide range of models. From 1.85 kW to 17.80 kW for heating, and from 3.80 kW to 13.70 kW for cooling.

## Space-saving and ultraquiet

The Yutaki S Combi unit can be installed in the kitchen thanks to its compact size and low noise level.

The large space saving of up to 70 % compared to other system is due to the innovative hot water tank integrated into the indoor unit.

## Choose your size

The Yutaki S Combi includes 2 tank models: 200 and 260 L

Moreover, the 2nd temperature kit can be incorporated into the 200 L unit.

## Easy installation and maintenance

Compared to a split system (indoor unit-hot water tank), the Yutaki S Combi allows fast installation with minimal costs since:

- All water and refrigerant connections are aligned at the top. (Fig. 1)
- Most components are accessible from the front of the unit.
- Easy access to information from the LCD control without having to open the indoor unit.

## Stainless steel tank with built-in heating element

The only compact model fitted with a hot water tank with backup heating element for emergency hot water, activated with a single button.

Fig. 1

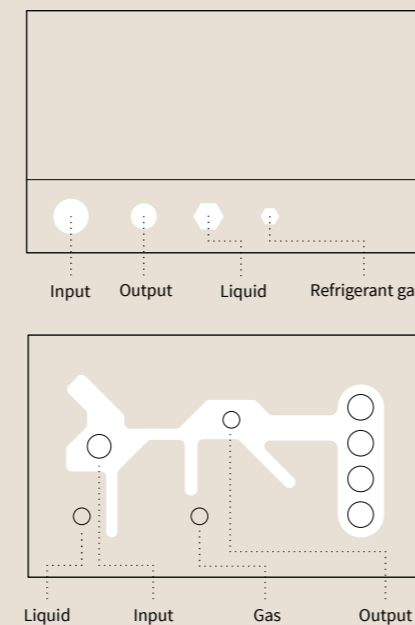

Indoor units

Outdoor units

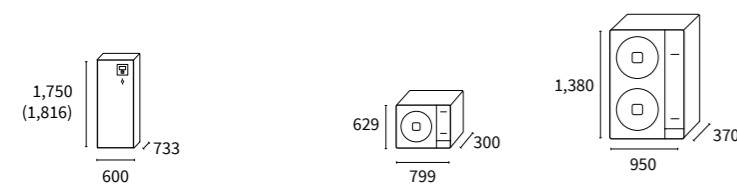

- RWD-2.0NRW(S)E RWD-4.0NW(S)E RAS-2WHVNRP RAS-4WH(V)NPE
- RWD-2.5NRW(S)E RWD-5.0NW(S)E RAS-2.5WHVNRP RAS-5WH(V)NPE
- RWD-3.0NRW(S)E RWD-6.0NW(S)E RAS-3WHVNRP RAS-6WH(V)NPE

# Yutaki S Combi

System			Yutaki S 2 Combi	Yutaki S 2.5 Combi	Yutaki S 3 Combi	Yutaki S 4 Combi	Yutaki S 5 Combi	Yutaki S 6 Combi
Capacity	Heating (Min/Nom/Max)	kW	1.85/4.30/6.50	1.85/6.00/8.60	2.10/8.00/11.00	4.30/11.00/15.20	4.80/14.00/16.70	5.50/16.00/17.80
	Cooling (Nom/Max)	kW	4.00/5.00	5.30/6.00	6.50/7.00	7.20/11.80	9.50/12.60	10.50/13.70
Consumption	Heating (Nom)	kW	0.82	1.25	1.65	2.20	2.97	3.50
	Cooling (Nom)	kW	1.00	1.47	1.94	2.18	2.68	3.17
Electrical power			1 ~230V 50Hz	1 ~230V 50Hz	1 ~230V 50Hz	1 ~230V 50Hz	1 ~230V 50Hz	1 ~230V 50Hz
			-	-	-	3N ~400V 50 Hz	3N ~400V 50 Hz	3N ~400V 50 Hz
COP (Water 35°C, Ambient 7°C)	Nominal		5.25	4.80	4.60	5.00	4.71	4.57
EER (Water 7°C, Ambient 35°C)	Nominal		3.12	3.60	3.35	3.54	3.54	3.31
Hot water energy rating (Profile L - 200l)			A+	A+	A+	A+	A+	A+
Seasonal efficiency hot water, COP <sub>ohw</sub> / ηs (Profile L - 200l)			3.30/132	3.30/132	3.30/132	3.25/130	3.25/130	3.25/130
Hot water energy rating (Profile XL - 260l)			A+	A+	A+	A+	A+	A+
Seasonal efficiency hot water, COP <sub>ohw</sub> / ηs (Profile XL - 260l)			3.40/136	3.40/136	3.40/136	3.35/134	3.35/134	3.35/134
Energy rating at 35°C	Medium climate		A+++	A+++	A+++	A+++	A+++	A++
Seasonal efficiency at 35°C, SCOP / ηs			4.93/181	4.58/177	4.25/175	4.80/189	4.48/176	3.90/153
Energy rating at 55°C			A++	A++	A++	A++	A++	A++
Seasonal efficiency at 55°C, SCOP / ηs			3.58/133	3.38/130	3.25/125	3.50/137	3.43/134	3.23/126
ESEER			3.36	3.26	3.26	3.33	3.29	2.84
SEER / ηs	Single-phase		4.11/162	4.13/162	3.95/155	4.93/194	4.83/190	4.70/185
	Three-phase		-	-	-	5.05/199	4.92/194	4.78/188
Outdoor operating temperatures	Heating (DB)	°C	-20 to 25	-20 to 25	-20 to 25	-25 to 25	-25 to 25	-25 to 25
	Hot water (DB)	°C	-20 to 35	-20 to 35	-20 to 35	-25 to 35	-25 to 35	-25 to 35
	Cooling (DB)	°C	10 to 46	10 to 46	10 to 46	10 to 46	10 to 46	10 to 46
Water production temperatures	Heating	°C	20 to 60	20 to 60	20 to 60	20 to 60	20 to 60	20 to 60
	Hot water	°C	30 to 75	30 to 75	30 to 75	30 to 75	30 to 75	30 to 75
	Cooling	°C	5 to 22	5 to 22	5 to 22	5 to 22	5 to 22	5 to 22
Refrigerant pipe diameter	Liquid-gas	inches	1/4-1/2	1/4-1/2	1/4-5/8	3/8-5/8	3/8-5/8	3/8-5/8
Water pipe diameter	Input-output	inches	1-1	1-1	1-1	1-1/4 - 1-1/4	1-1/4 - 1-1/4	1-1/4 - 1-1/4
Hot water pipe diameter	Input-output	inches	3/4-3/4	3/4-3/4	3/4-3/4	3/4-3/4	3/4-3/4	3/4-3/4
<b>Indoor unit</b>			<b>RWD-2.0NRW(S)E</b>	<b>RWD-2.5NRW(S)E</b>	<b>RWD-3.0NRW(S)E</b>	<b>RWD-4.0NW(S)E</b>	<b>RWD-5.0NW(S)E</b>	<b>RWD-6.0NW(S)E</b>
Minimum water volume of the installation	l		28	28	28	38	46	55
Water flow	(Min-Nom-Max) m <sup>3</sup> /h		0.50 - 0.77 - 1.80	0.60 - 1.03 - 1.90	0.60 - 1.03 - 1.90	1.00 - 1.89 - 2.70	1.10 - 2.41 - 2.80	1.20 - 2.75 - 2.80
Emergency heating element in primary	Steps/Capacity n <sup>o</sup> /kW		3 / 1 - 1 - 1	3 / 1 - 1 - 1	3 / 1 - 1 - 1	3 / 2 - 2 - 2	3 / 2 - 2 - 2	3 / 2 - 2 - 2
Hot water emergency heating element	Steps/Capacity n <sup>o</sup> /kW		1 / 2.7	1 / 2.7	1 / 2.7	1 / 2.7	1 / 2.7	1 / 2.7
Sound power	dB(A)		37	37	37	39	39	39
Dimensions (H (with connections) x W x D)	mm		1,750(1,816) x600x733	1,750(1,816) x600x733	1,750(1,816) x600x733	1,750(1,816) x600x733	1,750(1,816) x600x733	1,750(1,816) x600x733
Tank weight 200l / 260l / 260l solar	kg		121/131/131	122/132/132	122/132/132	120/130/130	122/132/132	122/132/132
Solar pipe diameter (260l solar tank)	Input-output inches		1/2-1/2	1/2-1/2	1/2-1/2	1/2-1/2	1/2-1/2	1/2-1/2
Solar exchange surface (260l solar tank)	m <sup>2</sup>		0.37	0.37	0.37	0.37	0.37	0.37
Maximum current	Single-phase	A	27	27	27	41.5	41.5	41.5
	Three-phase	A	-	-	-	22.4	22.4	22.4
<b>Outdoor unit</b>			<b>RAS-2WHVNRP</b>	<b>RAS-2.5WHVNRP</b>	<b>RAS-3WHVNRP</b>	<b>RAS-4WH(V)NPE</b>	<b>RAS-5WH(V)NPE</b>	<b>RAS-6WH(V)NPE</b>
Air flow	m <sup>3</sup> /h		2,526	2,526	2,982	4,800	5,400	6,000
Sound pressure	dB(A)		46	47	50	49	50	50
Sound power	dB(A)		61	63	64	64	65	67
Minimum pipe length	m		3	3	3	5	5	5
Maximum pipe length	m		50	50	50	75	75	75
Maximum height difference (highest OU/lowest OU)	m		30/20	30/20	30/20	30/20	30/20	30/20
Compressor			Scroll DC Inverter	Scroll DC Inverter	Rotary DC Inverter	Scroll DC Inverter	Scroll DC Inverter	Scroll DC Inverter
Refrigerant			R32	R32	R32	R410A	R410A	R410A
Refrigerant charge (length without additional charge)	kg (m)		1.2 (10)	1.3 (10)	1.3 (10)	3.3 (15)	3.4 (15)	3.4 (15)
Additional refrigerant charge	g/m		15	15	15	60	60	60
Dimensions (H x W x D)	mm		600x792x300	600x792x300	600x792x300	1,380x950x370	1,380x950x370	1,380x950x370
Weight	kg		45	45	44	103	103	103
Maximum current	Single-phase/Three-phase		13/-	13/-	17/-	30/14	30/14	30/16

## Compatible controls and accessories:

**Remote control**  
PC-ARFHE  
Included

**Cooling Kit**  
ATW-CKM-01  
Can be used to switch machine operation to cold.

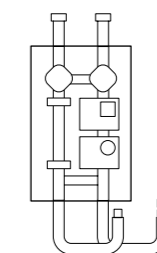

**2nd temperature kit**  
ATW-2TK-06  
Only compatible with built-in Yutaki S Combi 200L.  
ATW-2TK-07  
For wall-mounting. Compatible with the entire Yutaki range

# Internal design

Yutaki S Combi

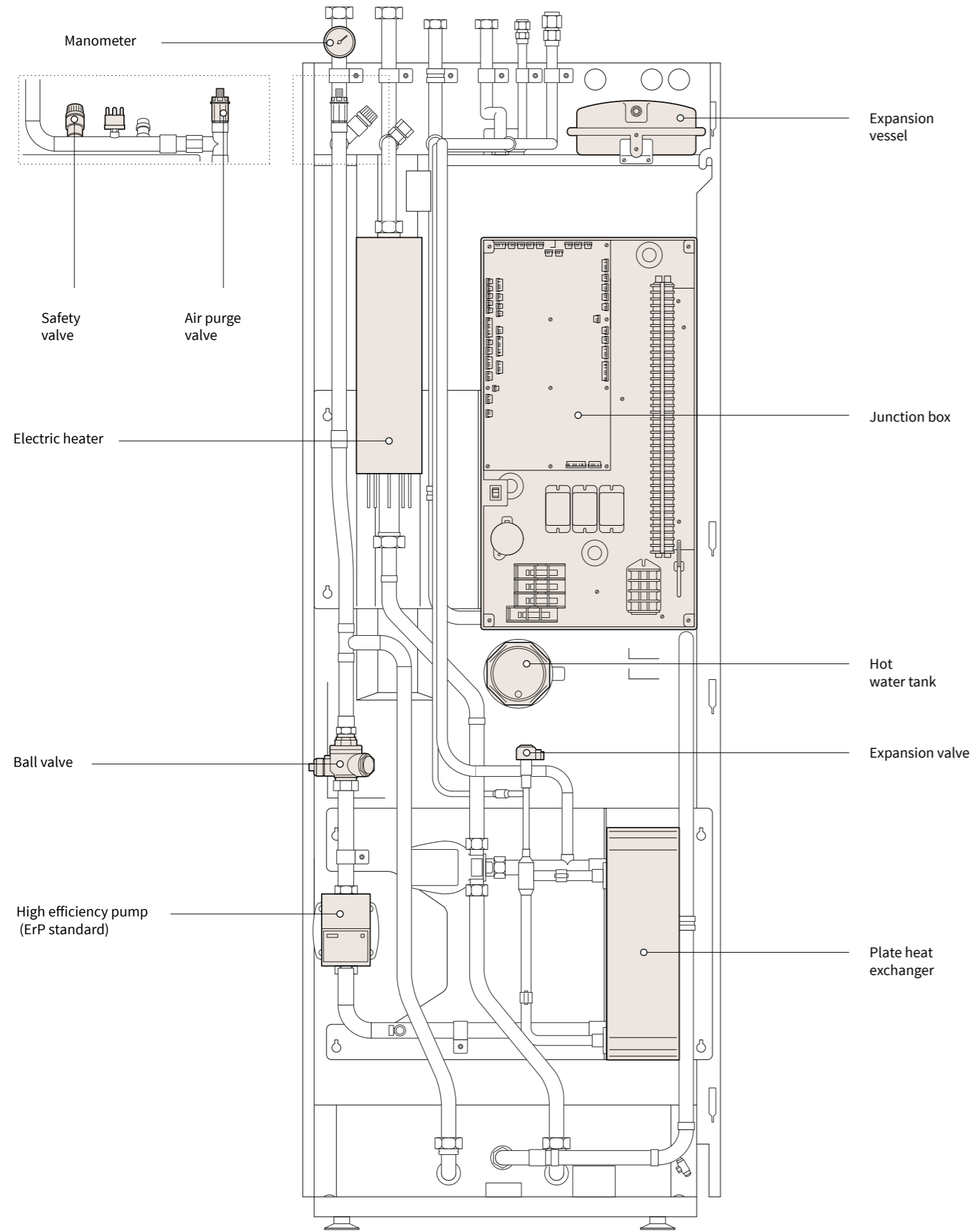

# Configurations

Radiator and underfloor heating at the same temperature; one zone + hot water by built-in tank.

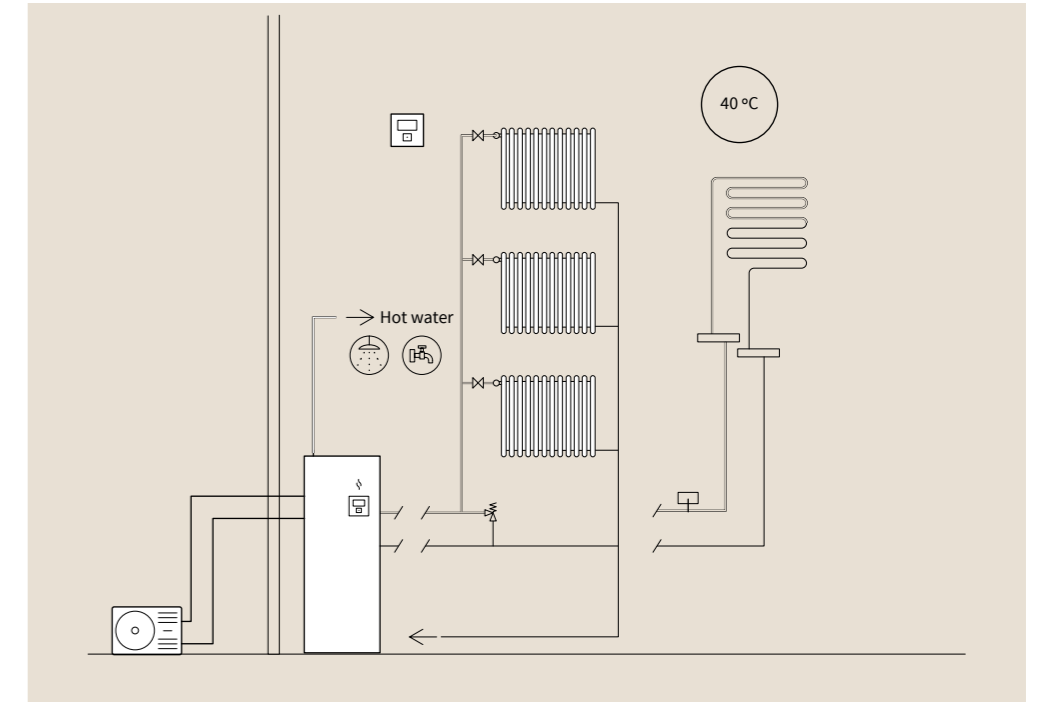

Radiator and underfloor heating at different temperatures; two zones + hot water by built-in tank.

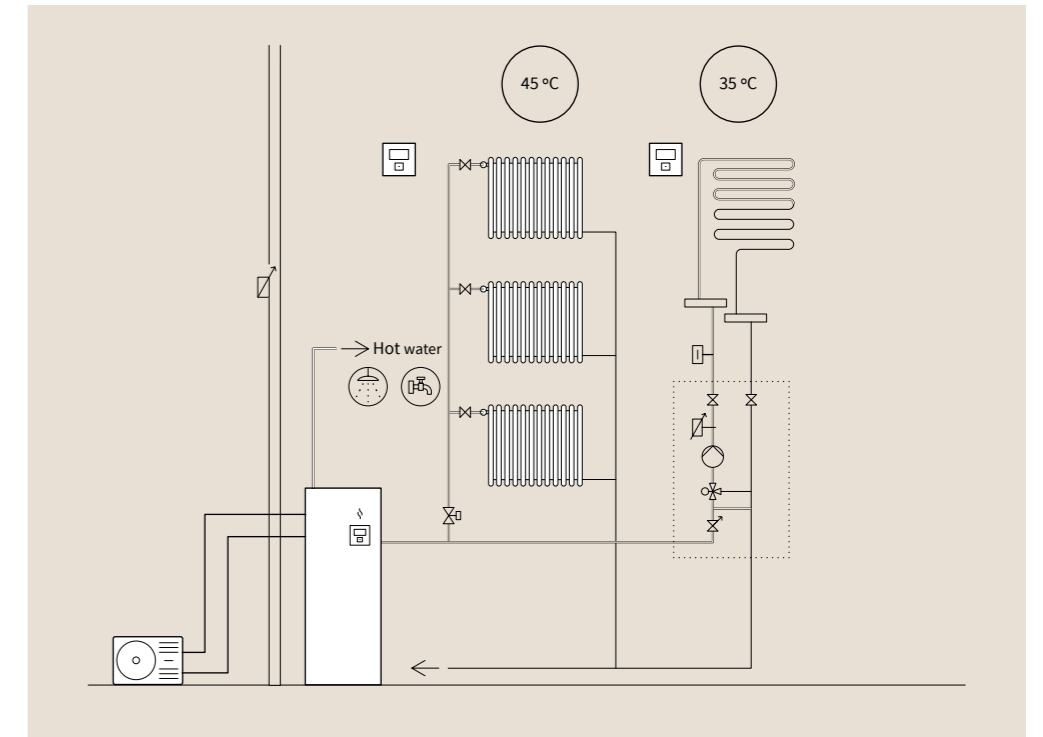

Yutaki ASHP

